

NCH Project Update to Temple Street Hospital

John Pollock, Project Director NPHDB



NATIONAL
PAEDIATRIC
HOSPITAL
DEVELOPMENT
BOARD

DESIGN
BUILD
EQUIP



working together for our children



The Project Elements

working together for our children...



An application for planning permission is being lodged for the following elements

NORTH SATELLITE



Connolly



SATELLITE CENTRES

The Satellite Centres are an integral part of, and come under the governance of, the new children's hospital.

This approach reflects best international practice for enhanced clinical outcomes by centralising highly specialised and complex tertiary and quaternary services and by localising secondary services as close to the child's home as possible.

SOUTH SATELLITE



Tallaght



CONSTRUCTION COMPOUND

Devitt Road



FAMILY ACCOMMODATION

Family accommodation is proposed adjacent to the new children's hospital on the campus at St James's Hospital. This will provide essential facilities for parents and siblings of sick children with extended hospital stays to enable them to stay together so that they can be with their sick child at what is a very traumatic time for all. This is especially important for families who reside outside of the Greater Dublin Area. The facility is connected to the new children's hospital through a shared basement.



CHILDREN'S RESEARCH & INNOVATION CENTRE

Children's Research and Innovation Centre, is an integral part of the new children's hospital, and will be co-located with the existing academic facilities on the campus at St James's Hospital.

This maximises clinical linkages and creates a centre of excellence for both paediatric and adult healthcare research on the campus.



NEW CHILDREN'S HOSPITAL



St James's Campus



The new children's hospital will be a world class facility to look after children and young people from all over Ireland who have complicated and serious illnesses and who are in need of specialist and complex care. Its completion will lead to a change in how acute health services are delivered and will result in improved survival rates for the sickest children and young people on the island of Ireland.



NATIONAL
PAEDIATRIC
HOSPITAL
DEVELOPMENT
BOARD

DESIGN
BUILD
EQUIP



CHILD
FRIENDLY
BY DESIGN

working together for our children

Highly Confidential



NCH Satellite Centres at Connolly & Tallaght

Satellite Centres: Key services

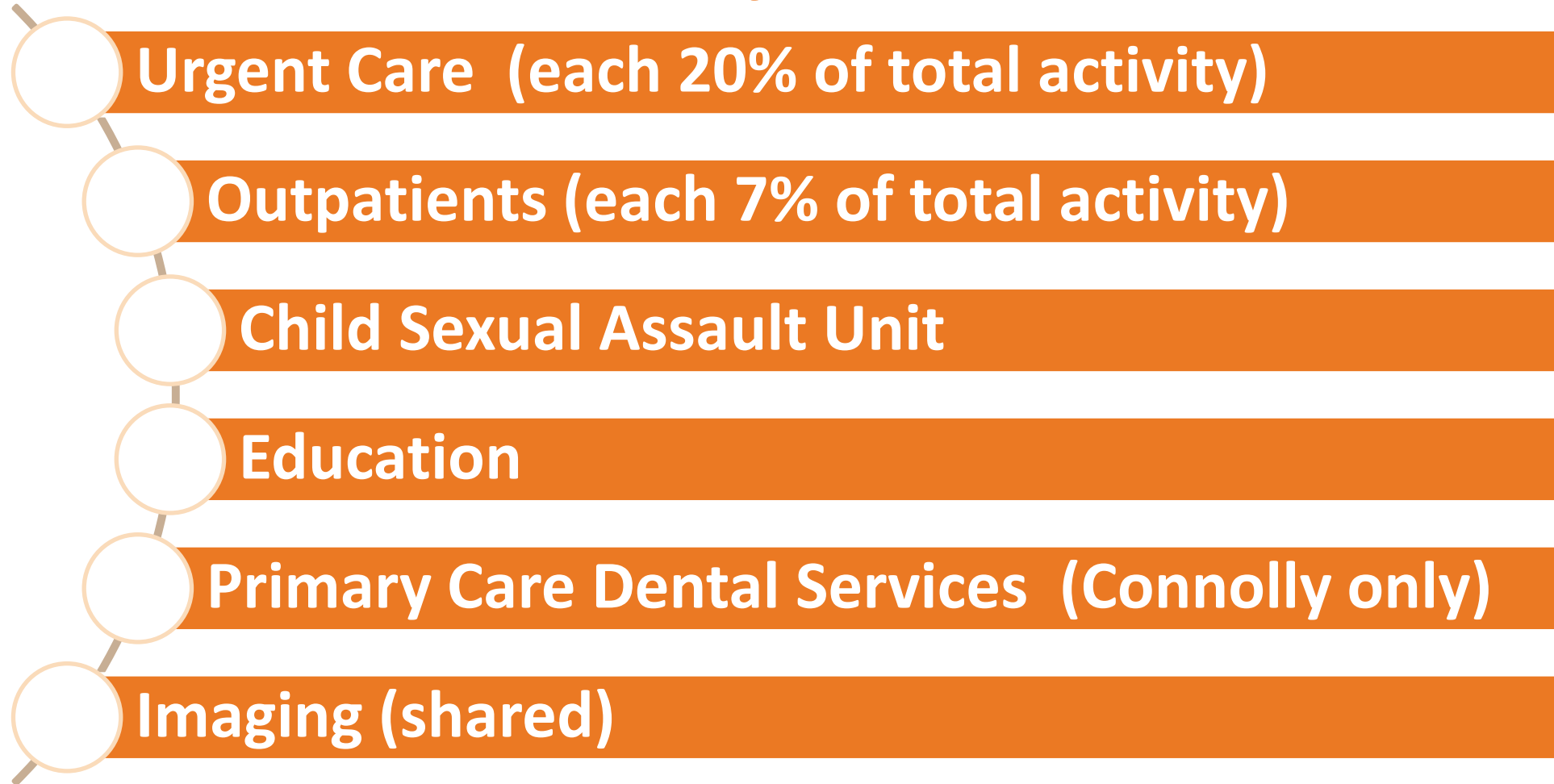

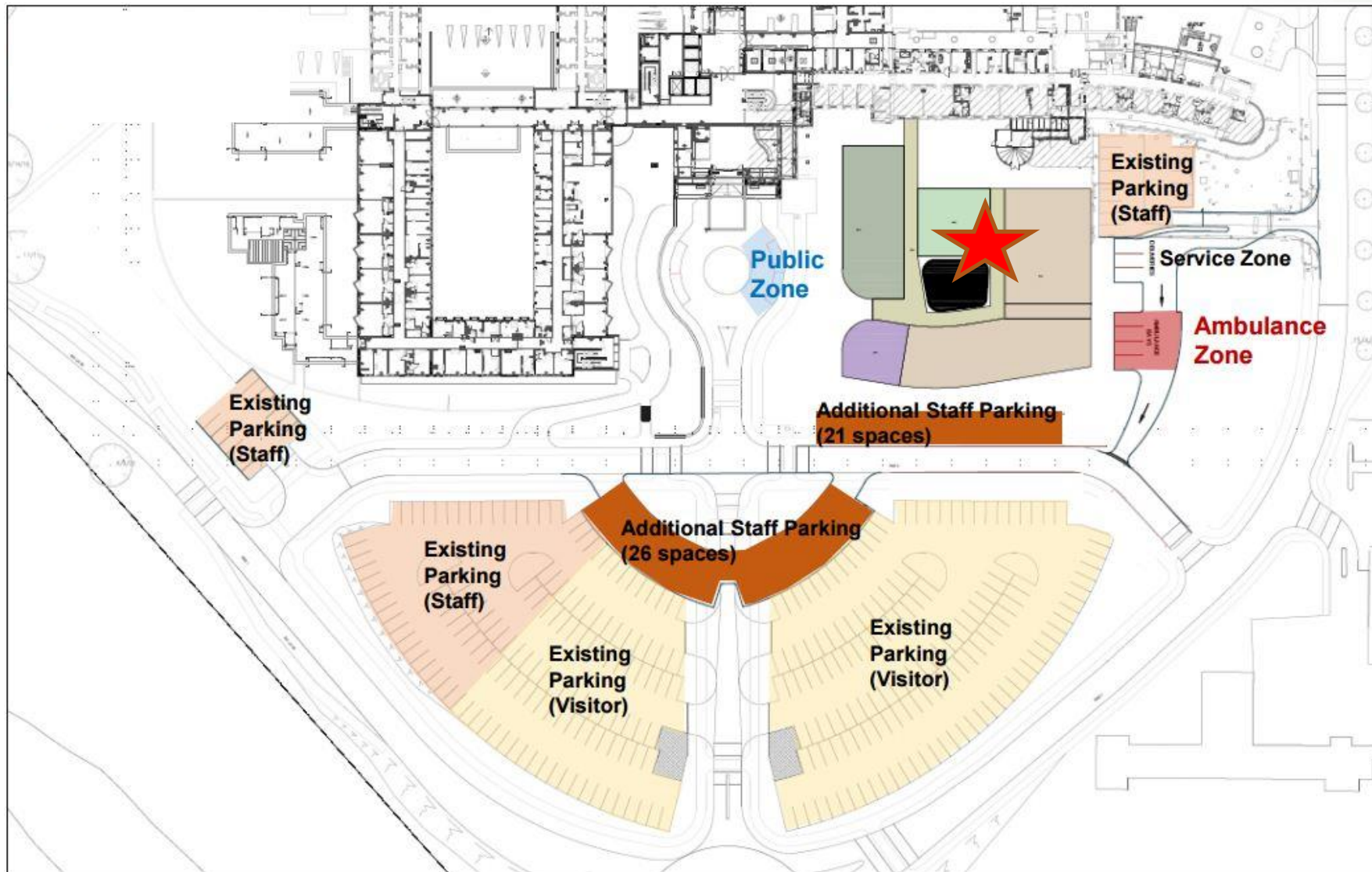

Proposed Traffic and Parking provision

Connolly Hospital

NATIONAL CHILDREN'S HOSPITAL SATELLITE CENTRES Coady Partnership ARCHITECTS

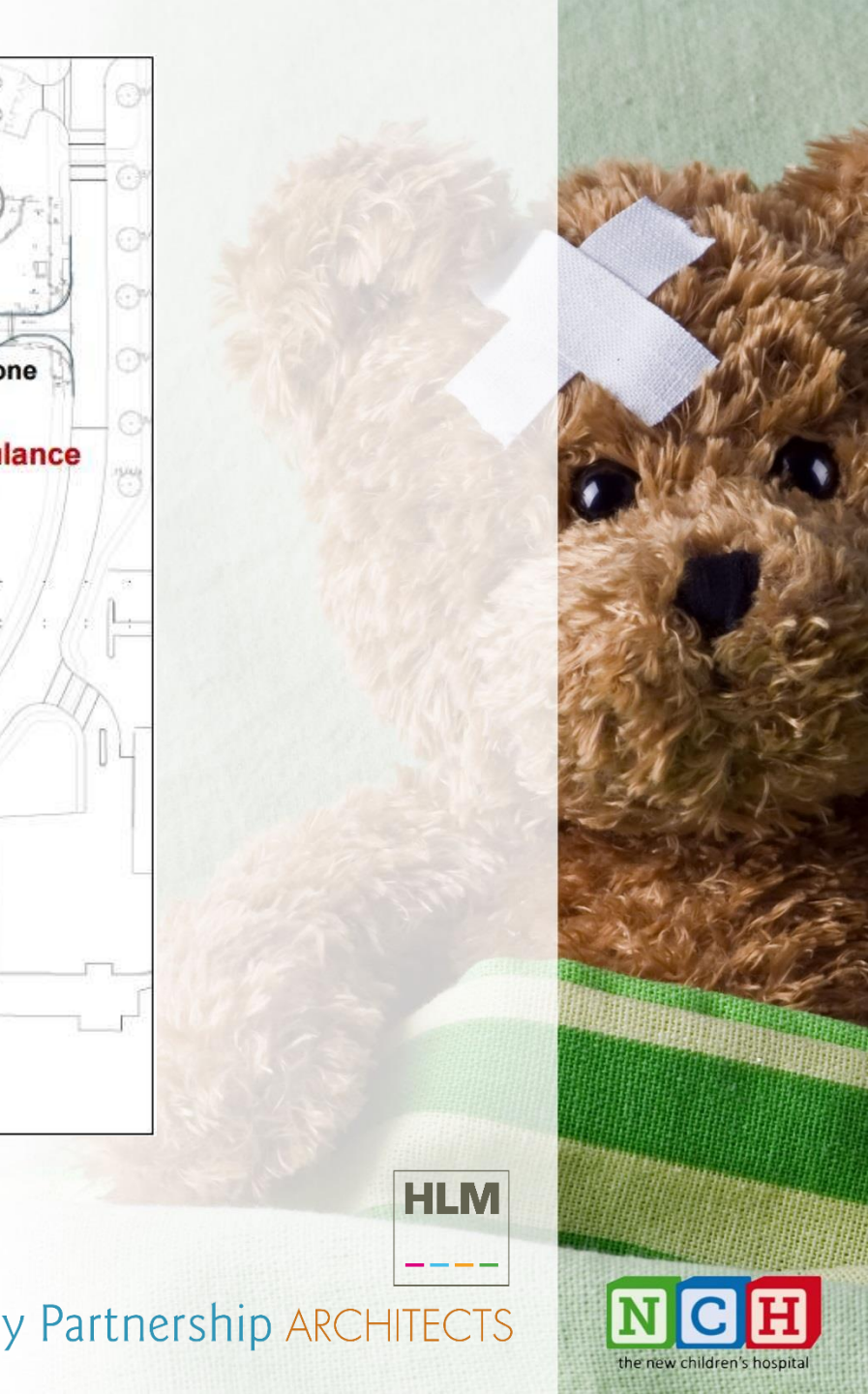



Site Photographs

1.2 Planning Deliverables – Connolly Existing NEW CHILDREN'S HOSPITAL SATELLITE CENTRES



Coady Partnership ARCHITECTS





3D Visualisation

Connolly Hospital

NATIONAL CHILDREN'S HOSPITAL SATELLITE CENTRES Coady Partnership ARCHITECTS





Connolly Hospital
NEW CHILDREN'S HOSPITAL SATELLITE CENTRES



Coady Partnership ARCHITECTS

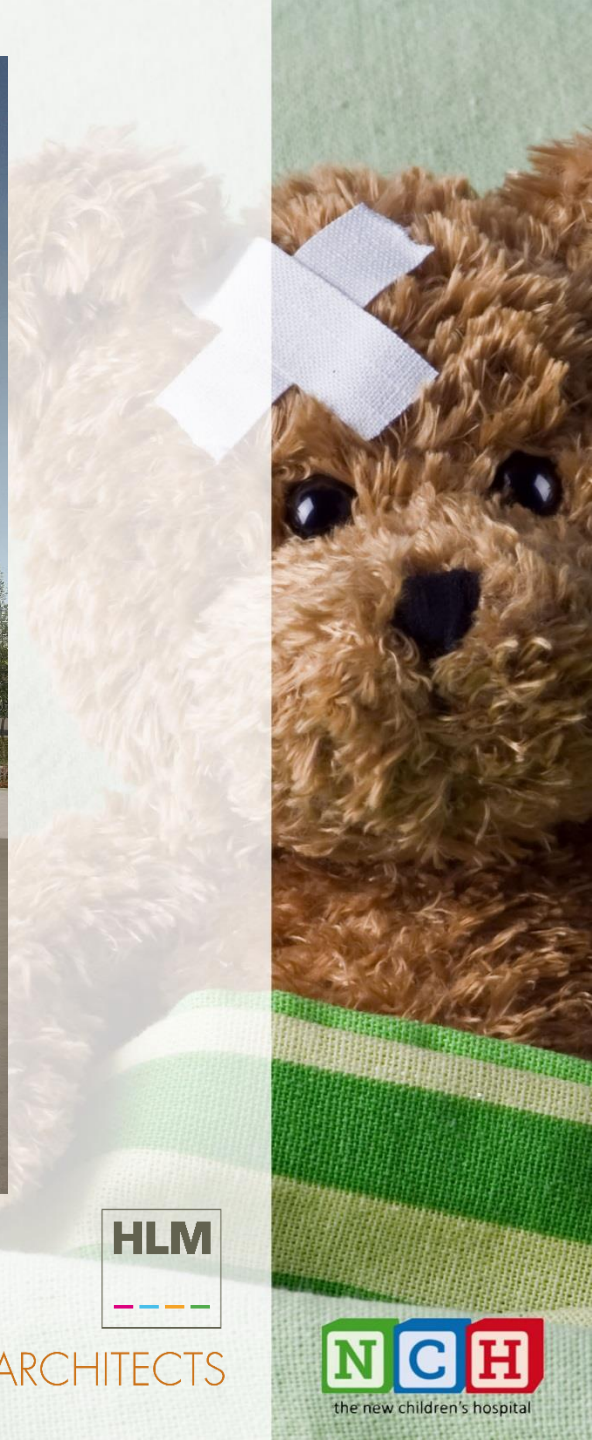

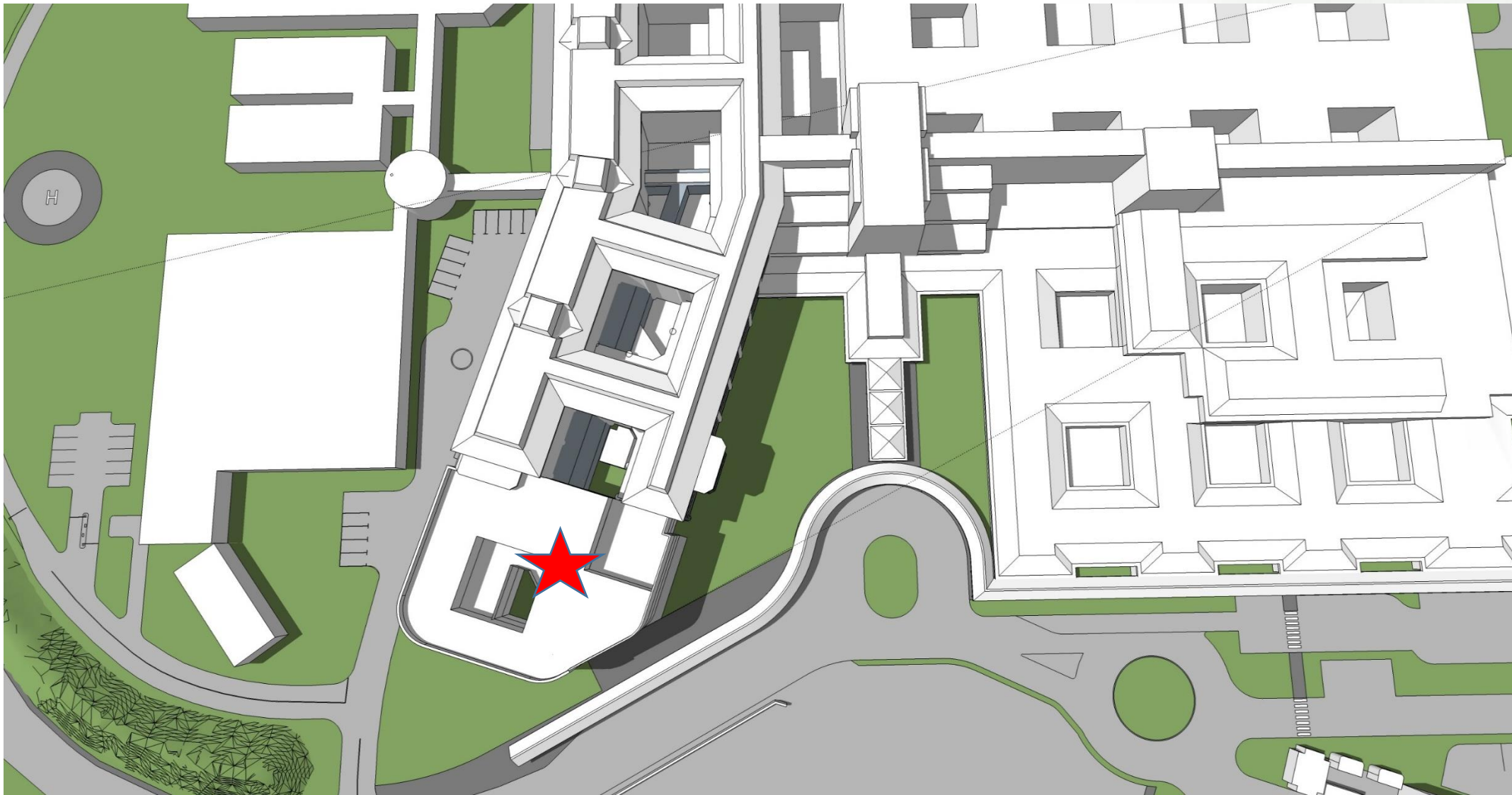

Site Massing

Tallaght Hospital
NEW CHILDREN'S HOSPITAL SATELLITE CENTRES



Coady Partnership ARCHITECTS



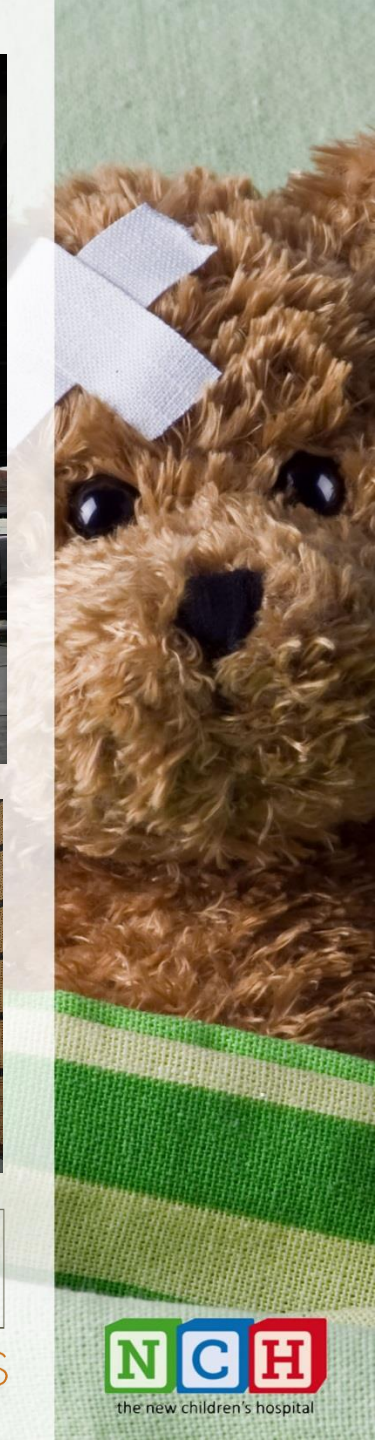

Site Photographs

Tallaght Hospital NEW CHILDREN'S HOSPITAL SATELLITE CENTRES



Coady Partnership ARCHITECTS





3D Visualisation

Tallaght Hospital
NEW CHILDREN'S HOSPITAL SATELLITE CENTRES



Coady Partnership ARCHITECTS





Tallaght Hospital
NEW CHILDREN'S HOSPITAL SATELLITE CENTRES



Coady Partnership ARCHITECTS



New Children's Hospital Project Update at St James's Campus

National Paediatric Hospital Project - SID Planning Application

(www.nchplanning.ie)

- **Main NCH at St James's Hospital campus (SJH), (160,000m² approx)**
 - 473 beds (380 In-patient & 93 day care). Single rooms with ensuite and family area
 - Advanced diagnostics, intervention and theatre facilities
 - Play areas, external gardens and courtyards
 - Therapy area with hydro pool & gym
 - Third Level Education Centre & Hospital School
 - 1,000 space car park (35,000m²)
 - Existing building to be demolished 20,000m²
- **Children's Research & Innovation Centre at SJH (3,000m² approx)**
- **53 bed family accommodation unit adjacent to the hospital at SJH (4,400m² approx)**
- **Contractors holding compound for material deliveries at Davitt Roads (0.8ha site)**
- **Children's Hospital Satellite Centres at Tallaght & Connolly Hospitals (4,500m² & 5,000m² approx)**

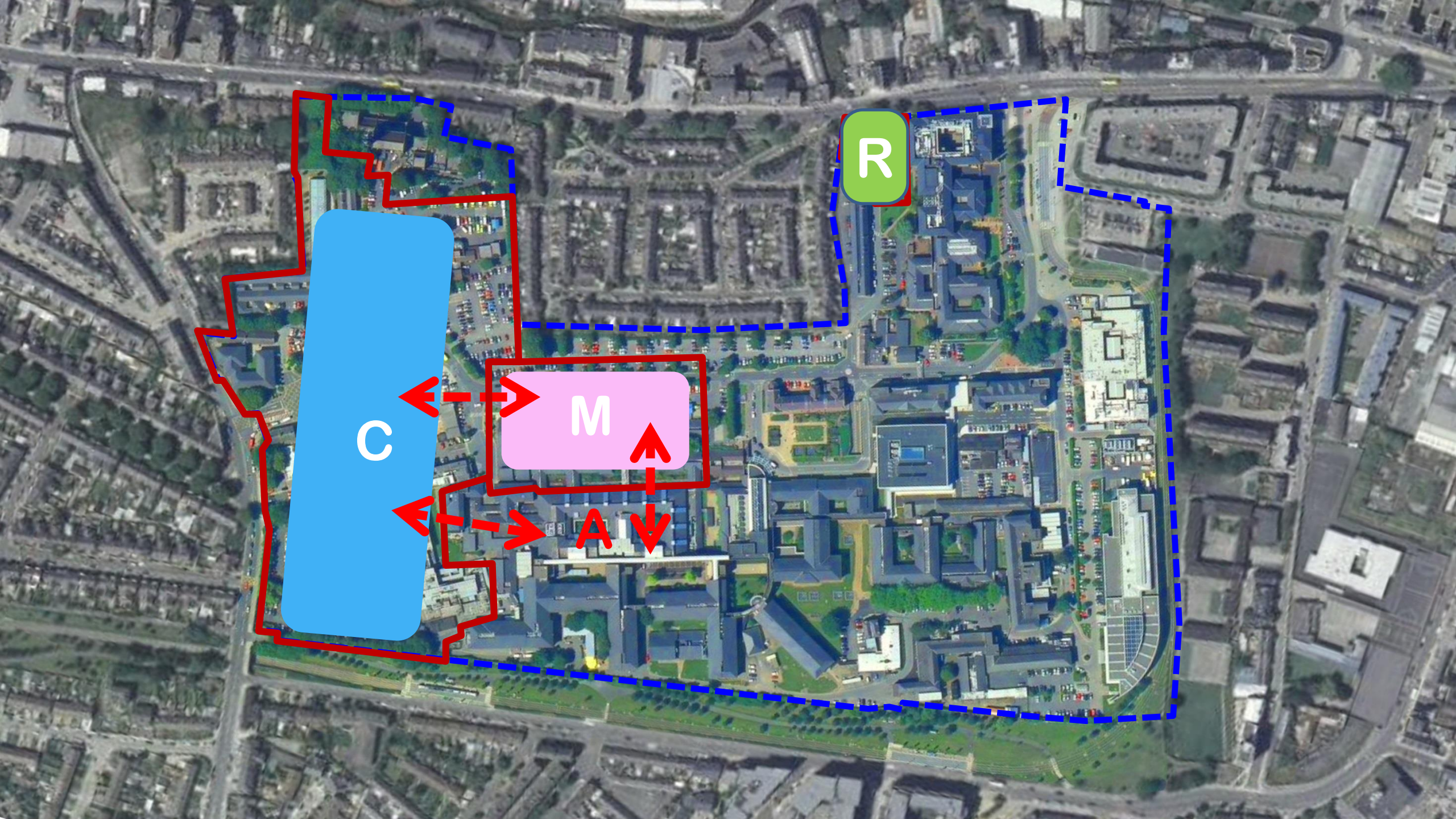

R

C

M

A





Children's Research & Innovation Centre



















Engagement

NPHDB and CHG have conducted over 1000 hours of engagement



Family Forum for the new children's hospital design

John (Dad), Fiona (Mum), Chloe (Child) and the hospital design team

FOR THE NEW CHILDREN'S HOSPITAL DESIGN
FAMILY FORUM

Thursday 20th February 2020 / 4.00pm - 6.00pm / F. Leary, The Phoenix Park, Dublin 16
Dear Family Forum Members,

You are invited to attend the Family Forum for the new children's hospital design. The forum is a chance for you to share your views on the design of the new hospital and to help us to make it a better place for your child.



working together for our children

- Young People and Parent Groups

Youth Advisory Council (YAC)

Family Forum

Children in Hospital Group

Tallaght Hospital Action Group

Advocacy Patient Forums

Special Needs Advocacy Patient Forums



- **Families** through patient advocacy groups and Hospital in Ireland were invited to attend a series of workshops
- **User Groups/ Staff** from the 3 existing children's hospitals, Connolly, Tallaght & St. James's Hospital

Engagement

NPHDB and CHG have conducted over 1000 hours of engagement...



A variety of drop-in sessions, meetings, briefings, information evenings have been held for key stakeholders to the project.

For residents:

- The Project team commenced a series of 'drop in' information sessions
- Leaflets informing residents about these sessions were distributed to over 4000 homes, councillors and TD's and resident associations were also invited.
- A regular resident newsletter 'connect' has been produced which includes a regular 'FAQ' section and images of the hospital as they are developed.
- Localised meetings with residents within close proximity to proposed construction took place and as a result of this engagement a number of actions were taken.



working together for our children



The Programme

Design commenced

6th August 2014

Planning submission to An Bord Pleanála,
incl. CRIC, RMHC, Satellites & Davitt Rd

10th August '15

Start Construction Procurement

August '15

Planning decision

February 2016

Start construction main NCH

March 2016

Commence transition of services
to the Satellites at Tallaght & Connolly

Q4 2017

Commence transition of services
to the new children's hospital

Q4- 2019